

Eurolan 12- and 24-fiber MTP backbone trunk cables and cassettes installation

This installation guide describes the method of installing simple 12- or 24-fiber backbone MTP cables into the Eurolan MTP panel system.



Preparation of cable gland

The cable gland is size M25.

The cable gland contains a rubber ring with four holes, with each hole corresponding to one MTP trunk.

Cut into the rubber ring so that you create longitudinal access to the holes.



Insert the required number of MTP trunk cables into the gland and assemble the parts together, leaving the nut free.



1. Installation procedure of four MTP trunk cables through one gland

Set the length (L) of the MTP cable trunks according to Table No.1. The cable's number corresponds with the MTP cassette number.

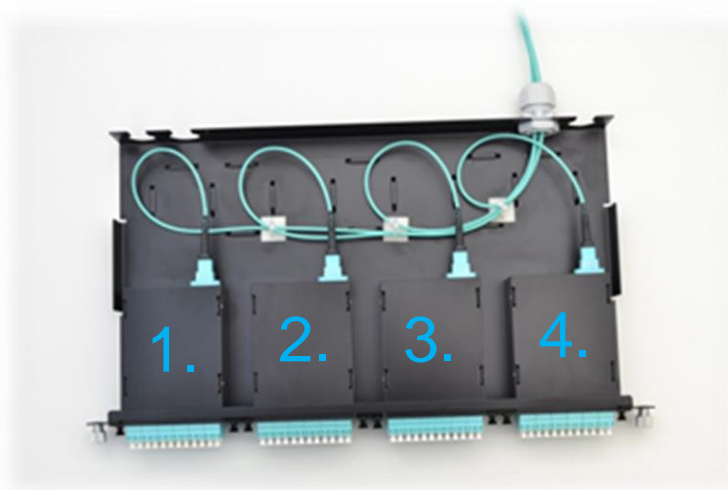
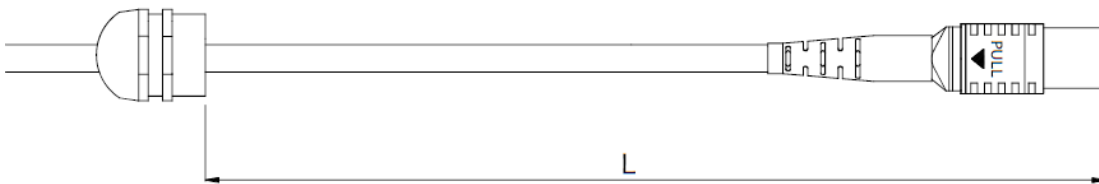

Length of cable (L)	
1.	62.5 cm
2.	51 cm
3.	42 cm
4.	35 cm

Table No.1

Position the plastic twisters as shown in the picture.

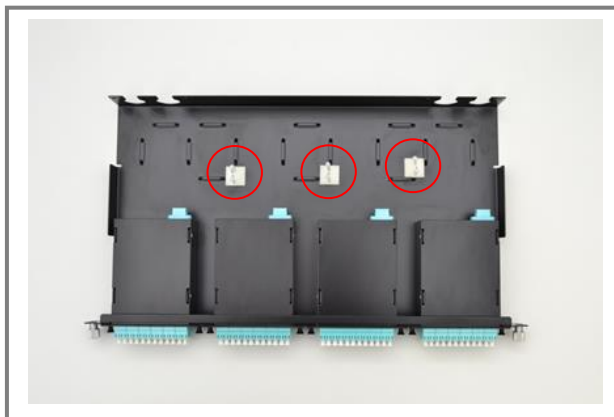

Fasten the trunk cable gland into the back plate on the right side by screwing down the gland's nut.

Take the first trunk cable and secure it into all twisters. Make a loop and plug it into the first MTP cassette. Repeat the same procedure for the second trunk cable and plug it into second MTP cassette. Attach the third trunk cable into the two twisters on the right side and plug it into the third MTP cassette.

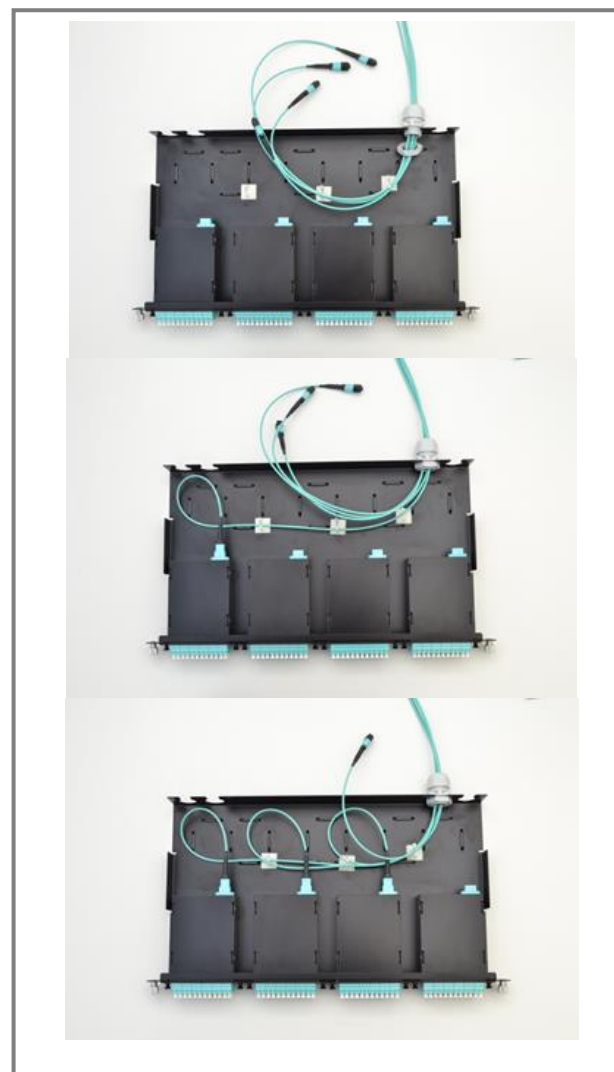

Attach the last trunk cable only into the nearest twister and plug it into the last MTP cassette.



2. Installing eight MTP trunk cables through two glands

Set the length (L) of the MTP cable trunks according to Table No.2.

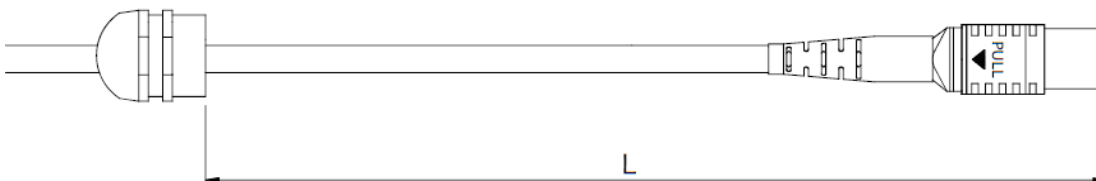

Trunk cable	Length of cable (L)	MTP Cassette
1.	44 cm	2.
2.	44 cm	2.
3.	35 cm	1.
4.	35 cm	1.
5.	44 cm	3.
6.	44 cm	3.
7.	35 cm	4.
8.	35 cm	4.

Table No.2

Position the plastic twistors as shown in the picture.

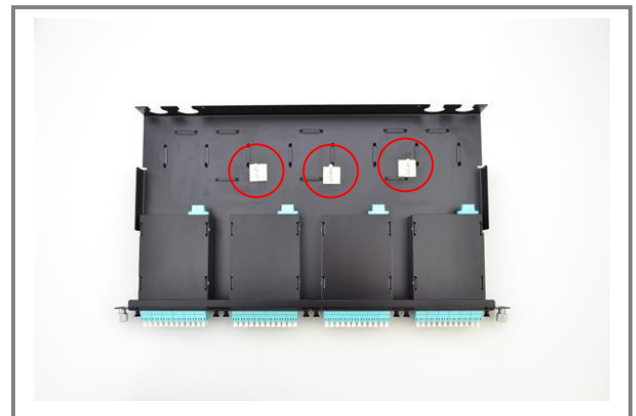

Fasten the cable gland into the back plate on the right side by screwing down the gland's nut.

Take the first two trunk cables and attach them into the first two twistors on the right side. Make a loop and plug them into the second MTP cassette.

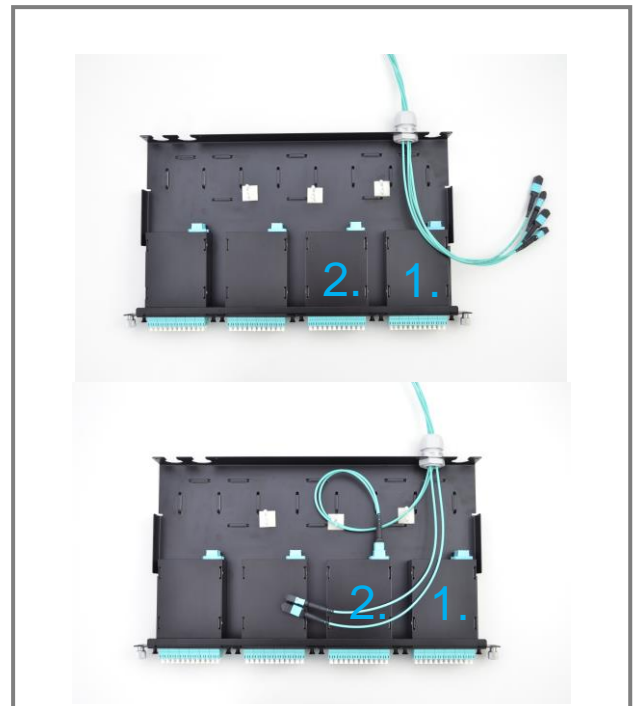

Gather the next two trunk cables and attach them only into the nearest twister and plug them into the first MTP cassette.

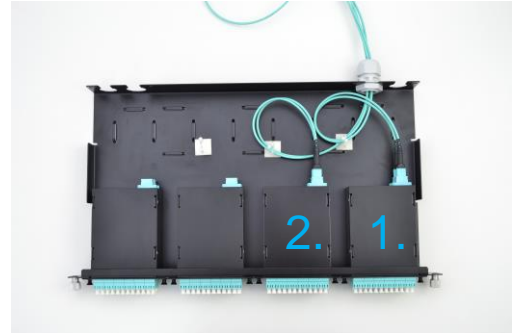

Repeat the same procedure for the next four cables from the left side.

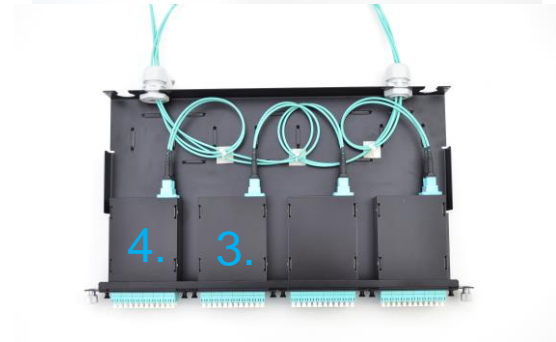
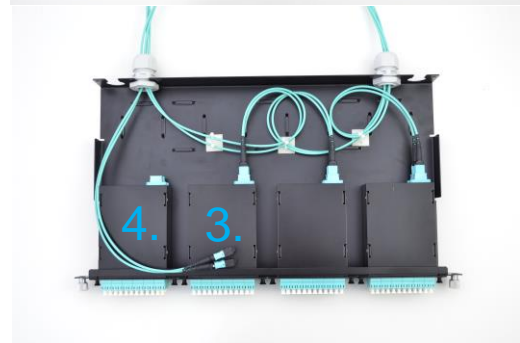

For more information, contact our sales team at moscow@eurolan.com

* Specifications are subject to change without notice.