

INSTALLATION SHEET

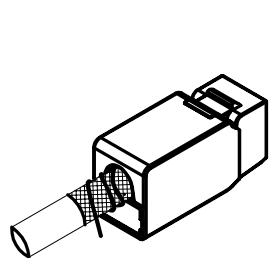

Step 1:
Properly terminate
a screened keystone
jack with screened
cable for DIN RAIL
grounding connection.

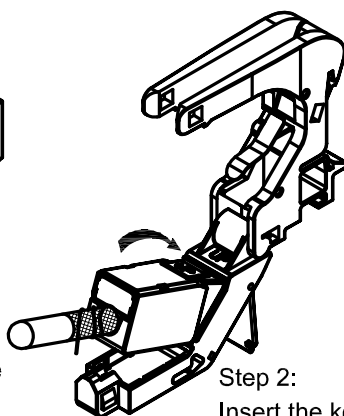

Step 2:
Insert the keystone
jack into DIN RAIL
module, make sure
the jack latch facing up.

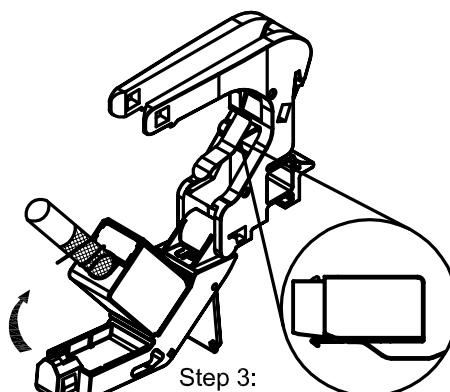

Step 3:
Lock the module and
make sure the grounding
spring contacts the jack
to ensure grounding
connection.

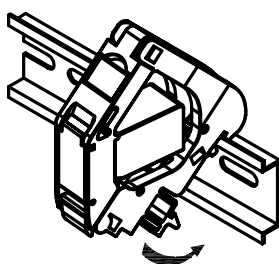

Step 4:
Insert the DIN RAIL module
at the top and rotate to click.

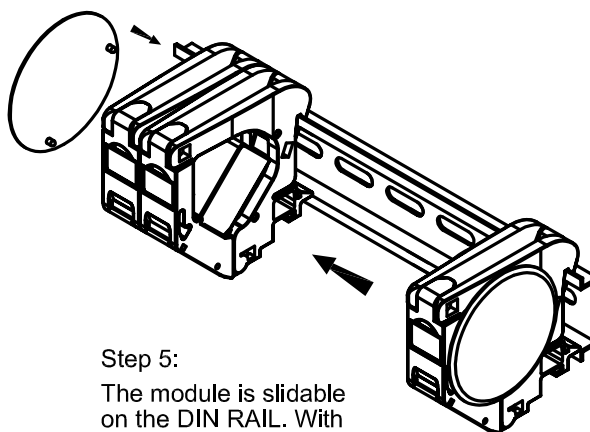

Step 5:
The module is slidable
on the DIN RAIL. With
rows of modules, covers
are only needed for the
right and left ends of the row.

Remove:

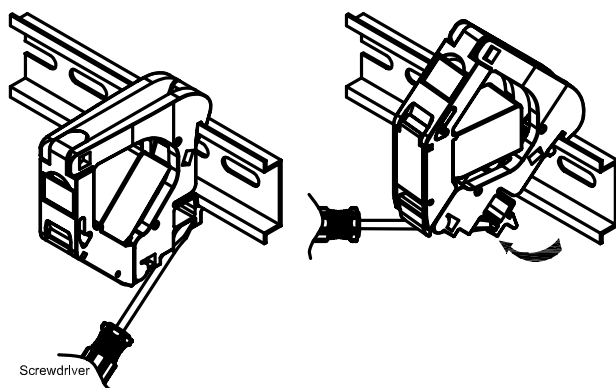

Insert a screwdriver into the opening
at the bottom of the module and
use it as a lever to pull out the module.

Open:

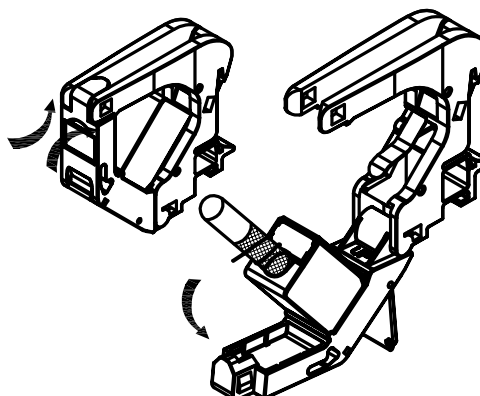

Use screwdrivers or fingers to
open the poles at the top of
the module.