

INSTRUCTION

1

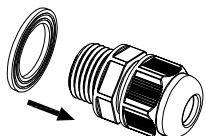

Place O-ring over the threads of the waterproof insert.

2

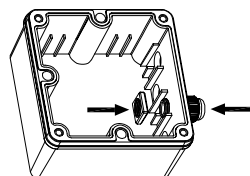

Place the treads of the insert through the hole in the box and using the nut fasten it into position.

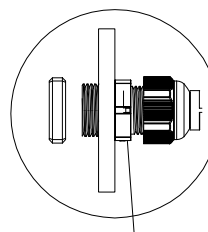

Nut
Suggested at least torque 3.5 N·m to lock tightly.

3

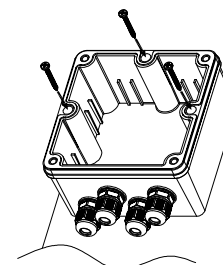

Secure the box to the wall with three screws.

4

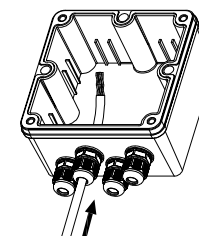

Inserts the industrial cable

through the waterproof insert.

5

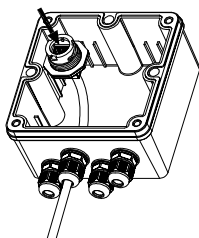

Terminating the cable onto the industrial connector using TIA568 A or B wiring.

6

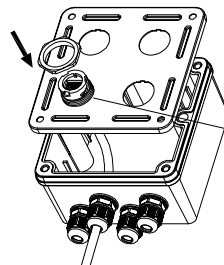

Put the threads of the industrial connector through the frame and then thread the plastic nut onto the industrial connector.

Nut
Suggested at least torque 3 N·m to lock tightly.

7

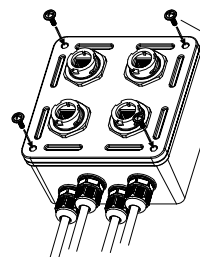

Attach the frame on the box using screws until snug.
Do not over tighten !

Screw
Suggested at least torque 1 N·m to lock tightly.

8

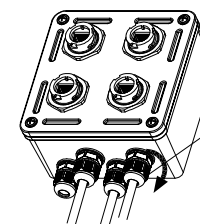

Tighten the waterproof plug by rotating to the right.

Nut Cap
Suggested at least torque 1 N·m to lock tightly.

9

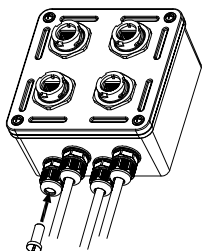

Insert the filler into any empty waterproof insert to seal the box.
The installation is now complete.
(Filler goes with 2 port upward box.)

