

Instruction Sheet

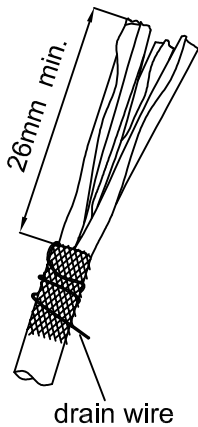

Step 1:

Strip 26 mm off jacket and fold braid to cover the jacket. Wrap the drain wire around the cable. The foil length of the wires passing are 3.5mm Min.

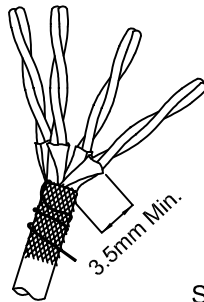

Step 2:

Insert the wires from the stripped cable into the cap through the hole

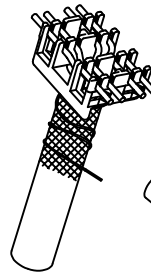
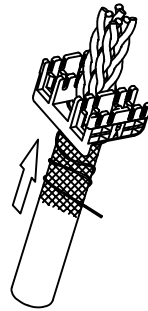

Step 3:

Insert the wires into their correct positions based upon the color code.

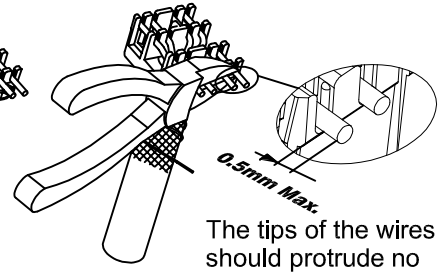

Step 4:

Cut the excess wire off as close to the edge of the cap as possible.

The tips of the wires should protrude no more than 0.5mm.

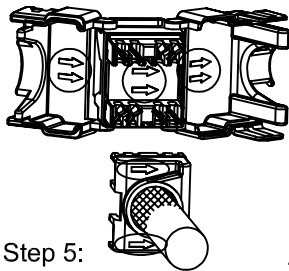

Step 5:

Make sure that the arrows on the jack and the cap face in the same direction. Put the cap into position.

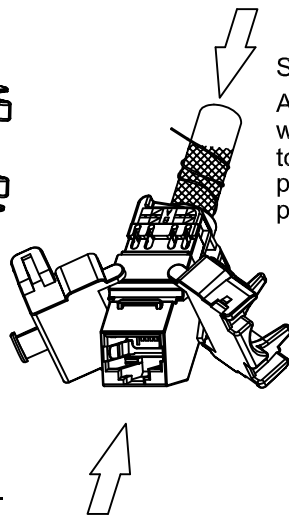

Step 6:

Align the cap with the IDC towers and press it into position.

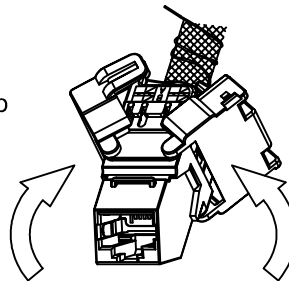

Step 7:

Rotate the wings toward each other until they snap closed.

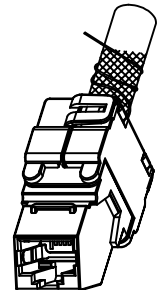

Step 8:

Ensure that the drain wire is wrapped around the cable and the strain relief ring for 360° screening connection.

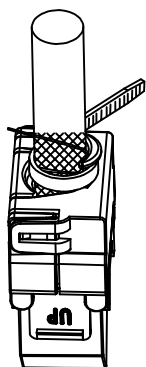

Step 9:

Tie wrap the drain wire to the strain relief ring. Do not overtighten the tie wrap! It should be snug but not so tight that it crushes the wires.

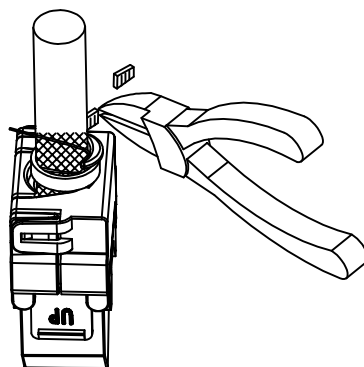

Step 10:

Cut the excess tie wrap off as close to the strain relief ring as possible. Ensure that the end of tie wrap is positioned as shown.

Disassembly Instruction:

Step 1:

Cut off the cable tie.

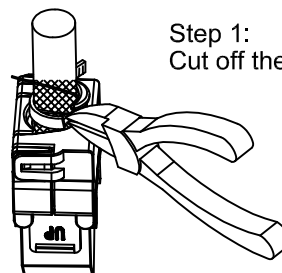

Screwdriver

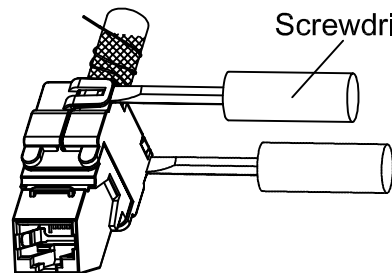

Step 2:

In order to remove the connector clip, insert a small screwdriver into the slot.