

Instruction Sheet

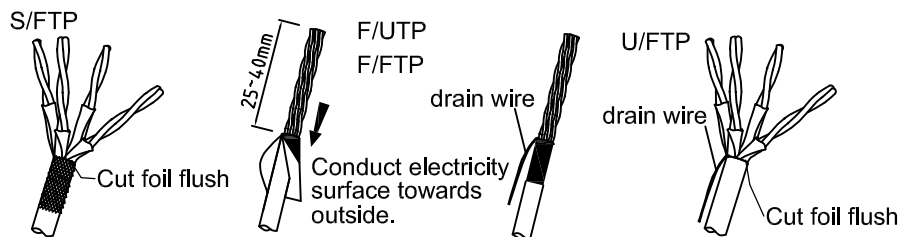

Step 1:

Strip the cable for minimum 25 mm, pull the foil or braided shield back over the jacket and wrap the drain wire around the shield.

NOTES:

IDC is suitable for 22~24AWG wires.

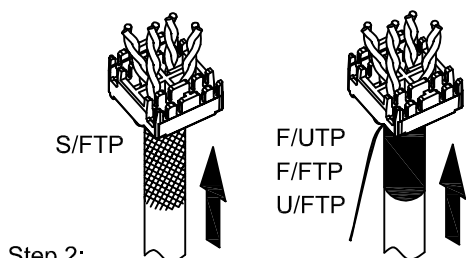

Step 2:

Insert the wires into the cap through the holes.

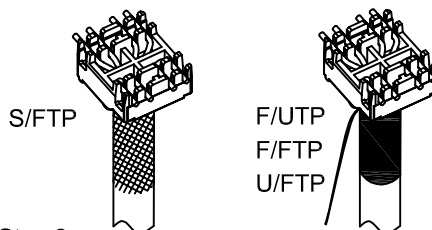

Step 3:

Lay the wires to their correct positions based on the color code. (T568A/T568B)

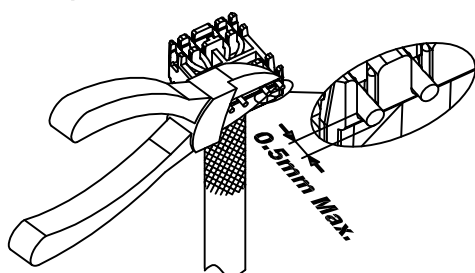

Step 4:

Cut the excess wires off. The tips of the wires should protrude no more than 0.5mm.

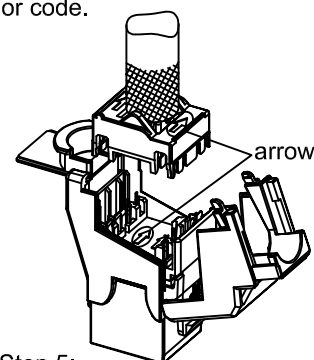

Step 5:

Put the cap on the IDC tower. The arrows on the jack and the cap should face the same direction. Put the cap into position.

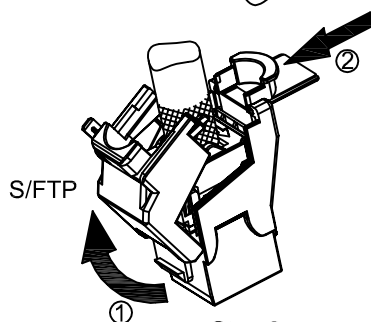

Step 6:

Close the jaw until it clicks into place. See circle ①. See circle ②; insert clip.

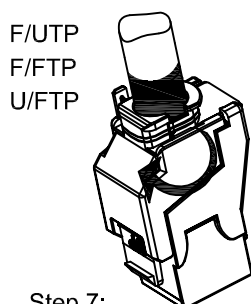
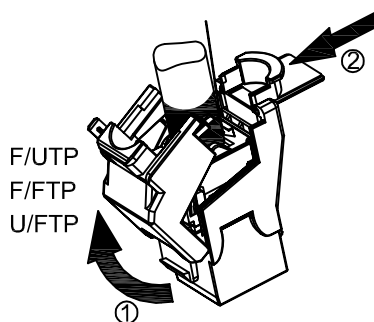

Step 7:

The drain wire should be wrapped around the strain relief as shown to ensure 360° shielded.

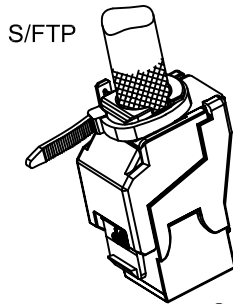

Step 8:

Fix the cable tie to the shielding lug.

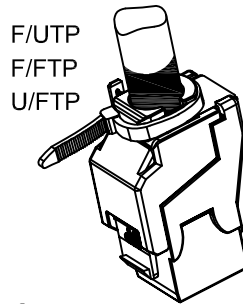

Disassembly Instruction:

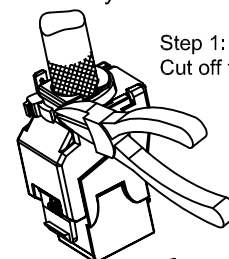

Step 1:

Cut off the cable tie.

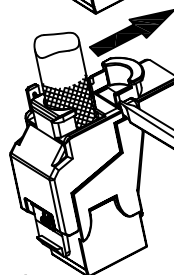

Step 2:

Pull out the shielding lug.

Screwdriver

Step 3:

Insert the screwdriver into the slot and rotate it to open the jaw.