

INSTRUCTION SHEET

STEP 1:

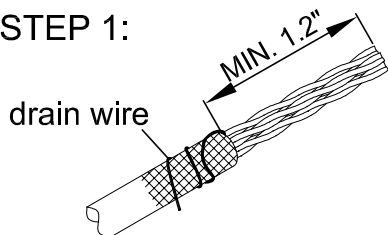

Strip off at least 1.2 inches of jacket from end of cable. Wrap the drain wire around the cable.

STEP 2:

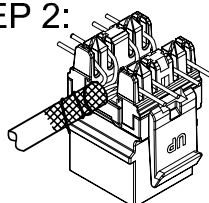

Press the wires through the projecting portion of terminals until fixed. (T568A/T568B)

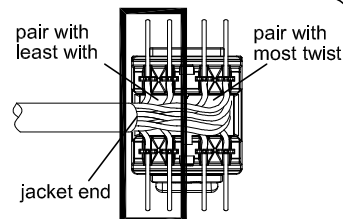

The pair with the least twist should be inserted into the IDC closest to where the jacket ends.

STEP 3:

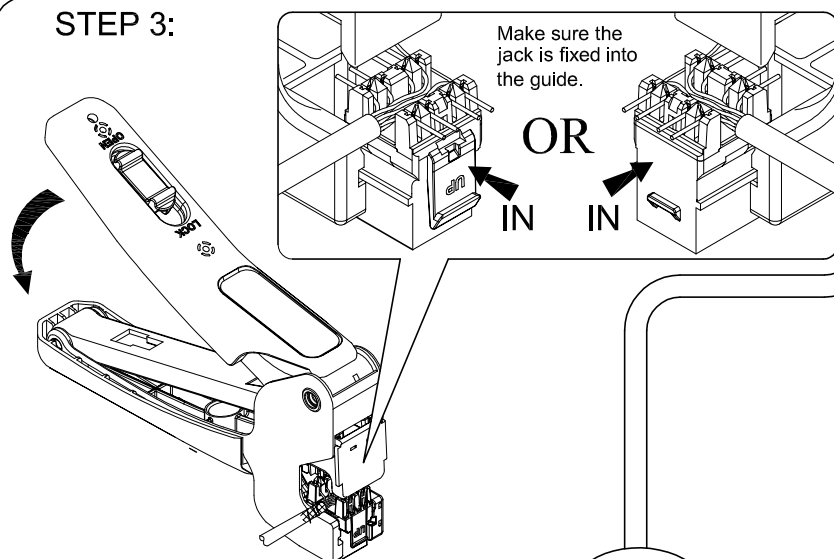

Insert the jack into the guide with either directions. Press tool to terminate the jack and cut off the excess wires.

OR

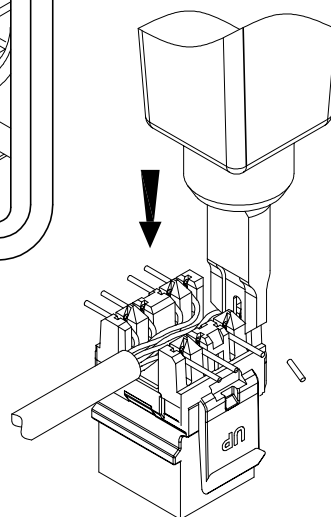

Terminate wires with punch down tool. Make sure the tool cuts off the excess wires.

STEP 4:

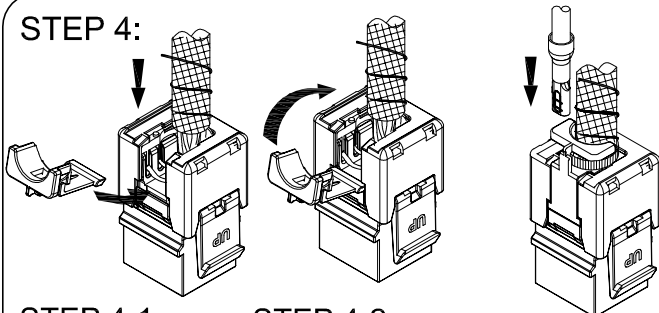

STEP 4-1:
Place the cap on the jack and press to make sure it is fully seated.
Put the hinged side cover into the slot.

STEP 4-2:
Snap the side cover to the jack.

STEP 4-3:
Fix the cable tie to the shielding lug. Insert the grounding wire into the grounding bar.

UNLOAD

