

# INSTRUCTION SHEET

## STEP 1:

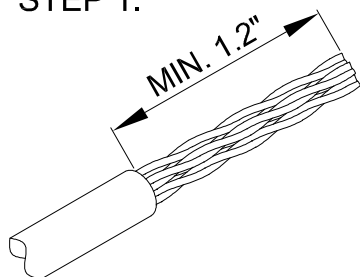

Strip off at least 1.2 inches of jacket from end of cable.

## STEP 2:

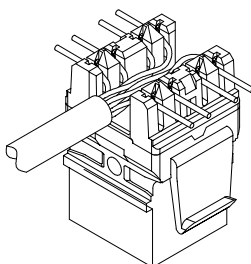

Press the wires through the projecting portion of terminals until fixed.

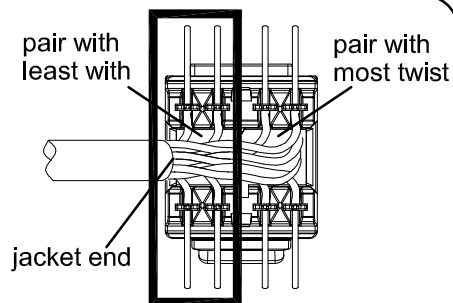

The pair with the least twist should be inserted into the IDC closest to where the jacket ends.

## STEP 3:

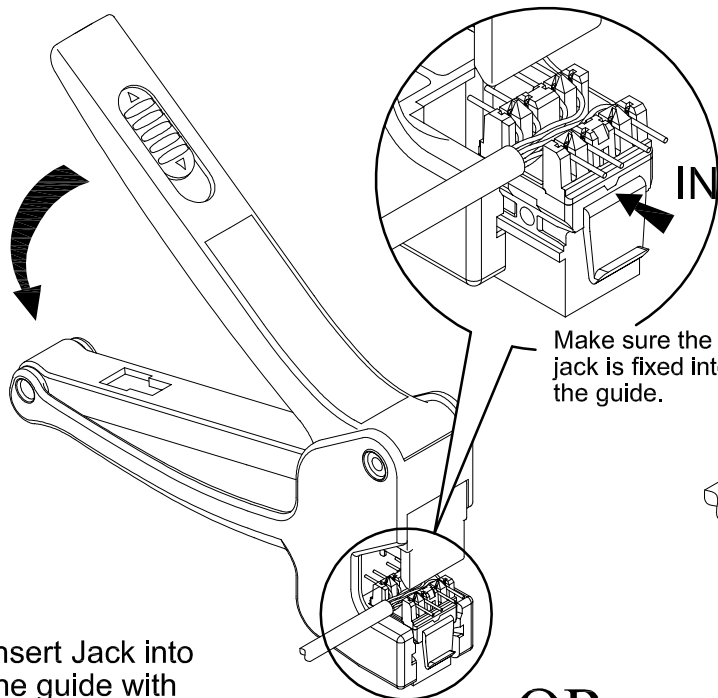

Insert Jack into the guide with either directions.

OR

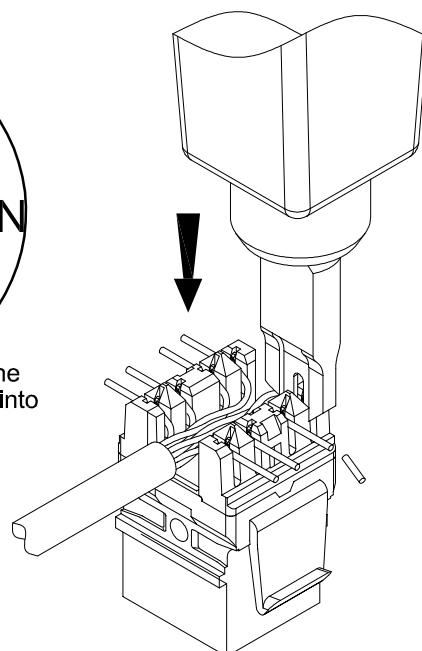

Terminate wires with punch down tool. Make sure the tool cuts off the excess wires.

## STEP 4:

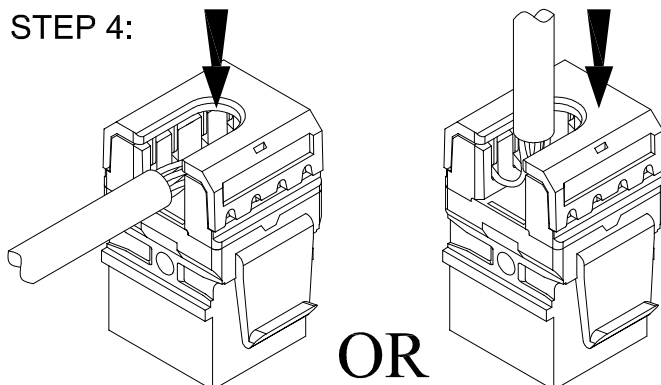

Place cap on Jack and press to make sure it is fully seated. The cap opening allows the cable enters the jack from side or rear.